

WASHERS

SCREW SIZE	MATERIAL	TYPE
#4 TO 1/4	MOLDED NYLON - WHITE	PLAIN

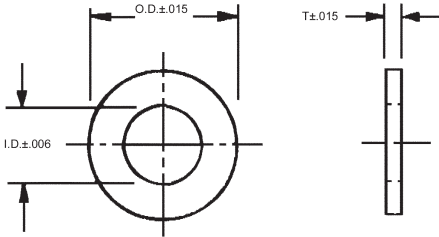

STOCK NO.	SCREW SIZE	OUTSIDE DIA.	I.D.	T
Z4-N-1	# 4	.281	.115	.047
Z4-N-3	# 6	.312	.140	.047
Z4-N-5	# 8	.375	.170	.062
Z4-N-7	# 10	.437	.200	.062
Z4-N-9	1/4	.562	.260	.062

SOLD IN PACKAGES OF 10.

SCREW SIZE	MATERIAL	TYPE
#000 TO 1/2	STAINLESS STEEL TYPE 18-8	SPLIT LOCK

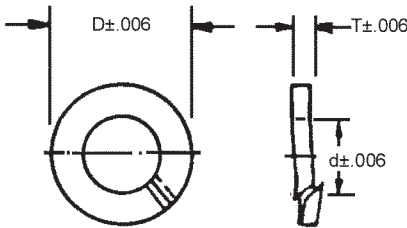

STOCK NO.	SCREW SIZE	D	d	T
Z3-000	#000	.093	.043	.020
Z3-00	#00	.093	.056	.020
Z3-0	#0	.130	.066	.020
Z3-1	#1	.150	.075	.020
Z3-2	#2	.166	.093	.020
Z3-4	#4	.203	.120	.025
Z3-6	#6	.244	.146	.031
Z3-8	#8	.287	.173	.040
Z3-10	#10	.327	.199	.047
Z3-12	1/4	.483	.261	.062
Z3-13	5/16	.580	.326	.078
Z3-14	3/8	.676	.390	.094
Z3-15	1/2	.875	.506	.125

SOLD IN PACKAGES OF 10.

SCREW SIZE	MATERIAL	TYPE
#000 TO 1/2	STAINLESS STEEL TYPE 18-8	PLAIN

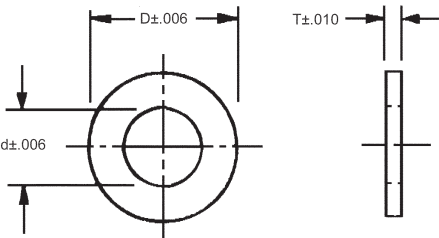

STOCK NO.	SCREW SIZE	D	d	T
Z4-000	#000	.090	.040	.012
Z4-00	#00	.108	.053	.015
Z4-0	#0	.156	.062	.020
Z4-1	#1	.187	.078	.020
Z4-2	#2	.187	.089	.031
Z4-4	#4	.312	.125	.031
Z4-6	#6	.375	.149	.031
Z4-8	#8	.375	.174	.031
Z4-10	#10	.438	.203	.063
Z4-12	1/4	.500	.265	.063
Z4-13	5/16	.562	.328	.063
Z4-14	3/8	.625	.390	.063
Z4-15	1/2	.750	.516	.093

SOLD IN PACKAGES OF 10.